

# iuta

iuta is a molded wire-mesh shell chair that provides an outstanding level of comfort. A variety of options make it an excellent choice for executive or meeting areas. The back is available in a distinctive pressed grey-painted steel mesh with profiled aluminum edging or in upholstered thermoplastic.

Designer: Antonio Citterio

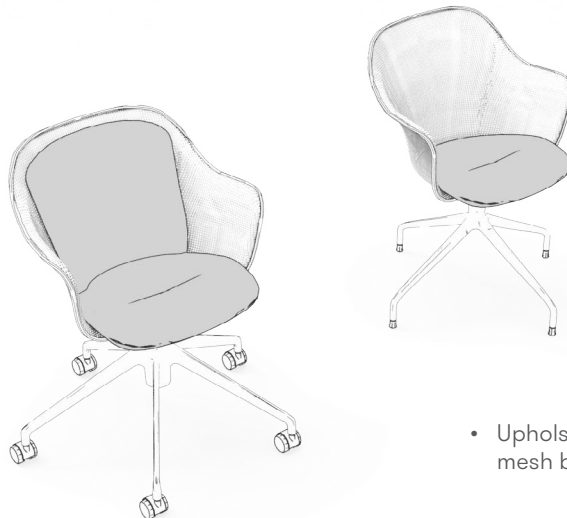

- Upholstered back or pressed grey-painted steel mesh back available

## dimensions

- Designed and tested for users up to 110kg/242 lbs
- Meets standard European NEN-16139 requirements

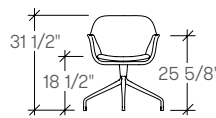
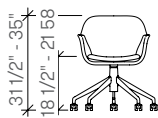
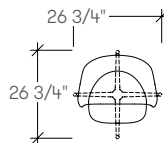
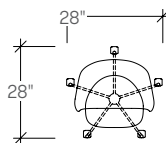

iuta 5-Star Chair, Ht. Adjustable  
 No Back Cushion - **BBUCCN**  
 With Back Cushion - **BBUCCY**

iuta 4-Star Chair  
 No Back Cushion - **BBUCEN**  
 With Back Cushion - **BBUCEY**

## COM/COL material requirement

Yardage is based on a non-patterned fabric. Additional yardage may be required for pattern repeats and the matching required. Leather yield may be affected by the quality of the COL. However, variance in the size of the hides will not affect the yield.

	COM [yards]	COL [sq. ft]
5-Star Chair (Upholstery Seat Only)	11/4	22
5-Star Chair (Upholstery Seat and Back)	11/2	27
4-Star Chair (Upholstery Seat and Back)	11/2	27
4-Star Chair (Upholstery Seat Only)	11/4	22

