

modular seating planning possibility

- Create Mixed-Activity zones and touch down spaces for temporary meetings
- The layout and orientation can be used to control the directionality of the users (face inward or outward)
- Arm rests assist with accessibility to the seat
- Reconfiguration Layout 'B' illustrates how a layout can encourage analog collaboration by focusing the orientation of the users inward

layout 02: curvilinear/serpentine

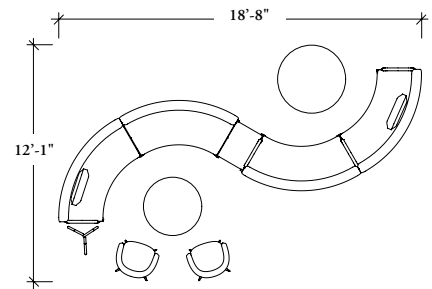

Dual Upholstery Shown

QUANTITY	COMPONENTS	DESCRIPTION	SINGLE UPHOLSTERY		DUAL UPHOLSTERY	
			LIST PRICE	EXTENDED PRICE	LIST PRICE	EXTENDED PRICE
2	ZNQWE	Arm, End of Run	175	350	175	350
2	ZNQPR	Pillow (Single Upholstery), Single Rectangular	175	350	175	350
2	ZNQWM	Arm, Mid-Run	200	400	200	400
1	ZNTR42	Low Round Tea Table, 42"dia	316	316	316	316
1	ZNTR36	High Round Tea Table, 36"dia	339	339	339	339
1	ZNAS	Coat Stand	371	371	371	371
1	ZNQTN	In-Line Table, No Cut Out	800	800	800	800
2	ZNSP	Zones Club Chair, Swivel Tilt with 4-Prong Base	1135	2270	1135	2270
2	ZNQINS	60° Concave Bench – Low-Back (Single Upholstery), No Electrical Module	2920	5840	3097	6194
2	ZNQJNS	60° Concave Bench – Hi-Back (Single Upholstery), No Electrical Module	3678	7356	3855	7710
TOTAL			18392	LIST	TOTAL	19100

Finishes: Grade 3 Fabric, Laminate Tables. *

See Price Guide for Dual Upholstery Product Codes

The following reconfigurations are possible using the same kit of parts.

reconfiguration a



reconfiguration b



modular seating planning possibility

reconfiguration a

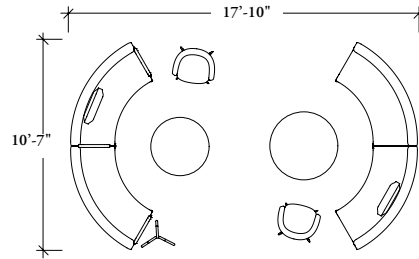

QUANTITY	COMPONENTS	DESCRIPTION	SINGLE UPHOLSTERY		DUAL UPHOLSTERY	
			LIST PRICE	EXTENDED PRICE	LIST PRICE	EXTENDED PRICE
2	ZNQWE	Arm, End of Run	175	350	175	350
2	ZNQPR	Pillow (Single Upholstery), Single Rectangular	175	350	175	350
1	ZNQWM	Arm, Mid-Run	200	200	200	200
1	ZNTSR42	Low Round Tea Table, 42" dia	316	316	316	316
1	ZNTTR36	High Round Tea Table, 36" dia	339	339	339	339
1	ZNAS	Coat Stand	371	371	371	371
2	ZNSP	Zones Club Chair, Swivel Tilt with 4-Prong Base	1135	2270	1135	2270
2	ZNQINS	60° Concave Bench – Low-Back (Single Upholstery), No Electrical Module	2920	5840	3097	6194
2	ZNQJNS	60° Concave Bench – Hi-Back (Single Upholstery), No Electrical Module	3678	7356	3855	7710
ADDITIONAL COMPONENTS REQUIRED FOR RECONFIGURATION A						
1	ZNQR	Bench End Caps (Set of 2)	125	125	125	125
			TOTAL	17517 LIST	TOTAL	18225 LIST

Finishes: Grade 3 Fabric, Laminate Tables. *

See Price Guide for Dual Upholstery Product Codes

reconfiguration b

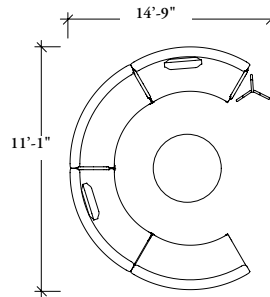

QUANTITY	COMPONENTS	DESCRIPTION	SINGLE UPHOLSTERY		DUAL UPHOLSTERY	
			LIST PRICE	EXTENDED PRICE	LIST PRICE	EXTENDED PRICE
1	ZNQWE	Arm, End of Run	175	175	175	175
2	ZNQPR	Pillow (Single Upholstery), Single Rectangular	175	350	175	350
2	ZNQWM	Arm, Mid-Run	200	400	200	400
1	ZNTSR42	Low Round Tea Table, 42" dia	316	316	316	316
1	ZNAS	Coat Stand	371	371	371	371
2	ZNQINS	60° Concave Bench – Low-Back (Dual Upholstery), No Electrical Module	2920	5840	3097	6194
2	ZNQJNS	60° Concave Bench – Hi-Back (Dual Upholstery), No Electrical Module	3678	7356	3855	7710
ADDITIONAL COMPONENTS REQUIRED FOR RECONFIGURATION A						
1	ZNQR	Bench End Caps (Set of 2)	125	125	125	125
			TOTAL	14933 LIST	TOTAL	15641 LIST

Finishes: Grade 3 Fabric, Laminate Tables. *

See Price Guide for Dual Upholstery Product Codes